

ALLDAY
& MILLER



Gerrard Gardens, Pinner, HA5 2PT
£535,000

2 1 2 E



Gerrard Gardens, Pinner, HA5 2PT

£535,000

- Great Opportunity For Re Development
- In Need Of Modernisation
- Extended To The Ground Floor
- Off Street Parking
- Side Space With Extension Potential
- Two Double Bedrooms
- A Short Walk From Coteford School
- Large Rear Garden

Description

A substantial development opportunity offering scope for redevelopment. Ready for buyers looking to make it their own and is perfect for those seeking to add a personal touch while carrying out some modernisation.

Featuring two generously sized bedrooms, offering comfortable living space, along with a bathroom and a kitchen.

A spacious reception room forms the heart of the home, providing excellent potential for a welcoming living area, while the dining room completes this property.

Externally, the front driveway offers convenient off-street parking. To the rear, a private garden provides a peaceful outdoor space, mainly laid to lawn.

Situation

Located on a quiet residential street, Gerrard Gardens in Pinner, is a highly desirable address offering a strong blend of village charm and everyday convenience. Particularly appealing to families due to its proximity to a number of well-regarded schools including Coteford Junior, West Lodge Primary School, Pinner Wood School, Haydon School and Pinner High School. Eastcote Ruislip and Pinner Underground Stations (Metropolitan/Piccadilly Lines) are within easy reach, providing fast and direct access to Central London, while excellent road links via the A40, A404 and M25 support wider commuting, and the area is well served by Eastcote & Pinner High Streets with its mix of independent shops, cafés, restaurants and supermarkets.



Floor Plans

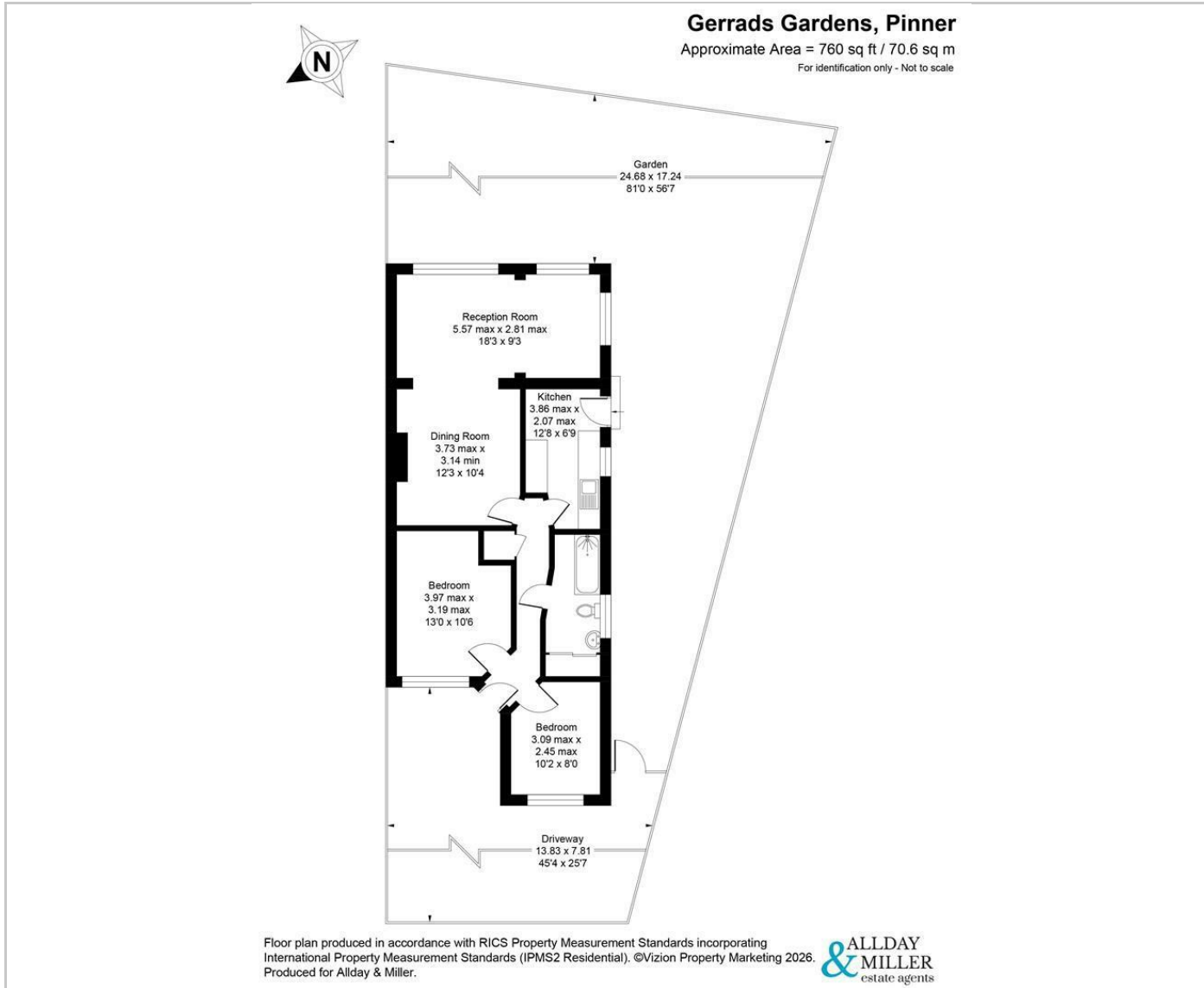

Area Map

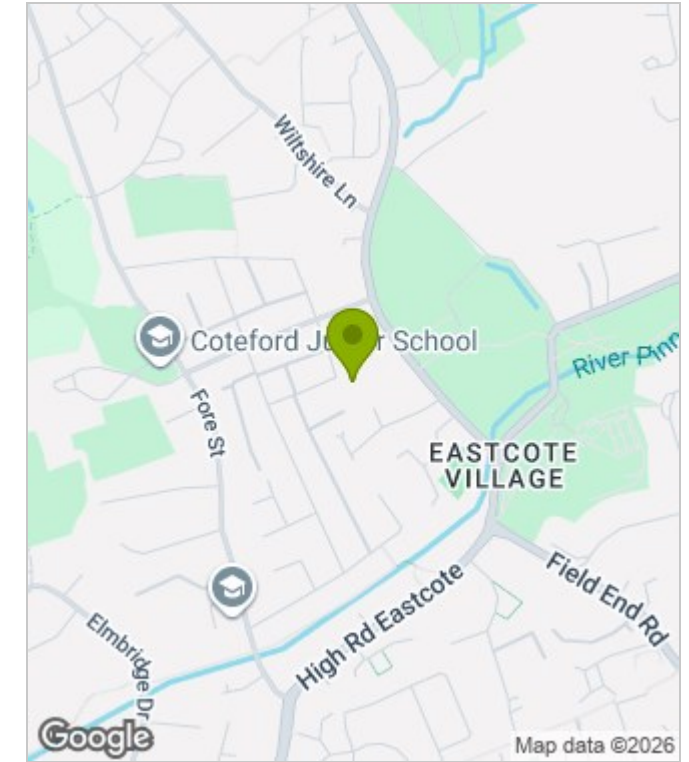

Energy Performance Graph

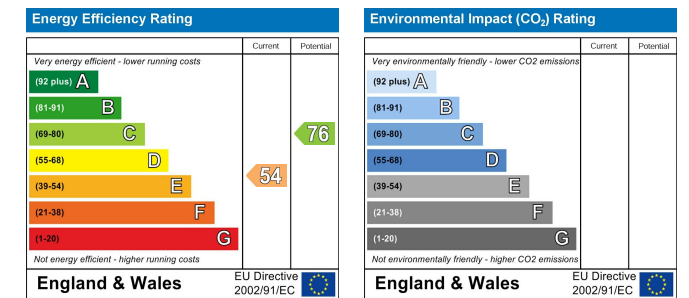

These particulars, whilst believed to be accurate are set out as a general outline only for guidance and do not constitute any part of an offer or contract. Intending purchasers should not rely on them as statements of representation of fact, but must satisfy themselves by inspection or otherwise as to their accuracy. No person in this firm's employment has the authority to make or give any representation or warranty in respect of the property.